



ASPIRE

— TO MOVE —



Lansdown Road, Bath, BA1

Video and physical viewings available. Two bedroom flat located on Lansdown Road, Bath. The flat benefits from a large open plan living space, private rear courtyard, and a single garage. Available 1st December and offered unfurnished. The landlord would consider two students.

Lansdown Mansions is located just north of Bath City centre. It provides good access into the city with Milsom street just 0.5 miles away. There is a bus stop located outside Lansdown Mansions providing access into Bath. Local shops can be found on Julian Road. 0.3 miles away.

£1,475 PCM

Lansdown Road, Bath, BA1

- Two double bedrooms
- Available 1st December
- Students considered
- Garage
- Unfurnished
- Council tax band D
- Rear courtyard
- Video viewing available
- Holding deposit: £340

Video and physical viewings available. Two bedroom flat located on Lansdown Road, Bath. The flat benefits from a large open plan living space, private rear courtyard, and a single garage. Available 1st December and offered unfurnished. The landlord would consider two students.

Lansdown Mansions is located just north of Bath City centre. It provides good access into the city with Milsom street just 0.5 miles away. There is a bus stop located outside Lansdown Mansions providing access into Bath. Local shops can be found on Julian Road. 0.3 miles away.

The property is located on the ground floor. The accommodation comprises of a kitchen, with base and wall units, cooker, hob, fridge and freezer. There is a utility room located off the kitchen which houses the washing machine and can be used for additional storage. The reception rooms are linked and provide a large open plan living space. The living dining room provides excellent space for dining table, chairs, sofa's etc. There are two bedrooms, both of which are doubles and both benefit from having wardrobe storage. The bathroom has shower over bath, WC and sink.

The property also benefits from a delightful rear courtyard and a single garage which can be used for parking or storage.

The property is available 1st December and would best suit two professional sharers, a couple or a small family. The landlord would consider two students.

Council tax band D: £2214.54

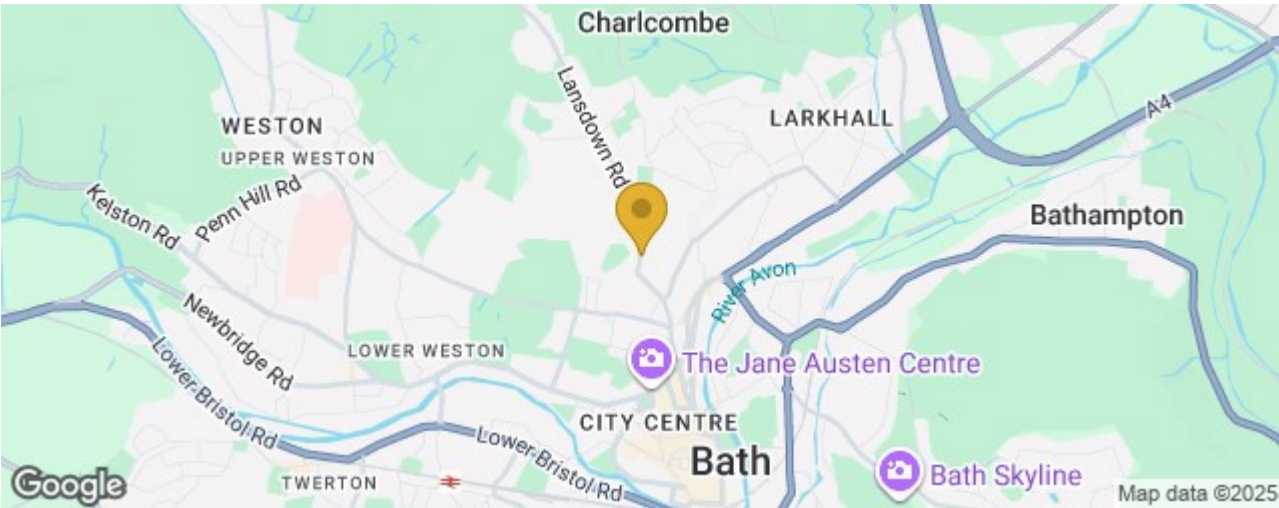



Floor Plan

GROUND FLOOR
797 sq. ft. (74.1 sq. m.) approx.

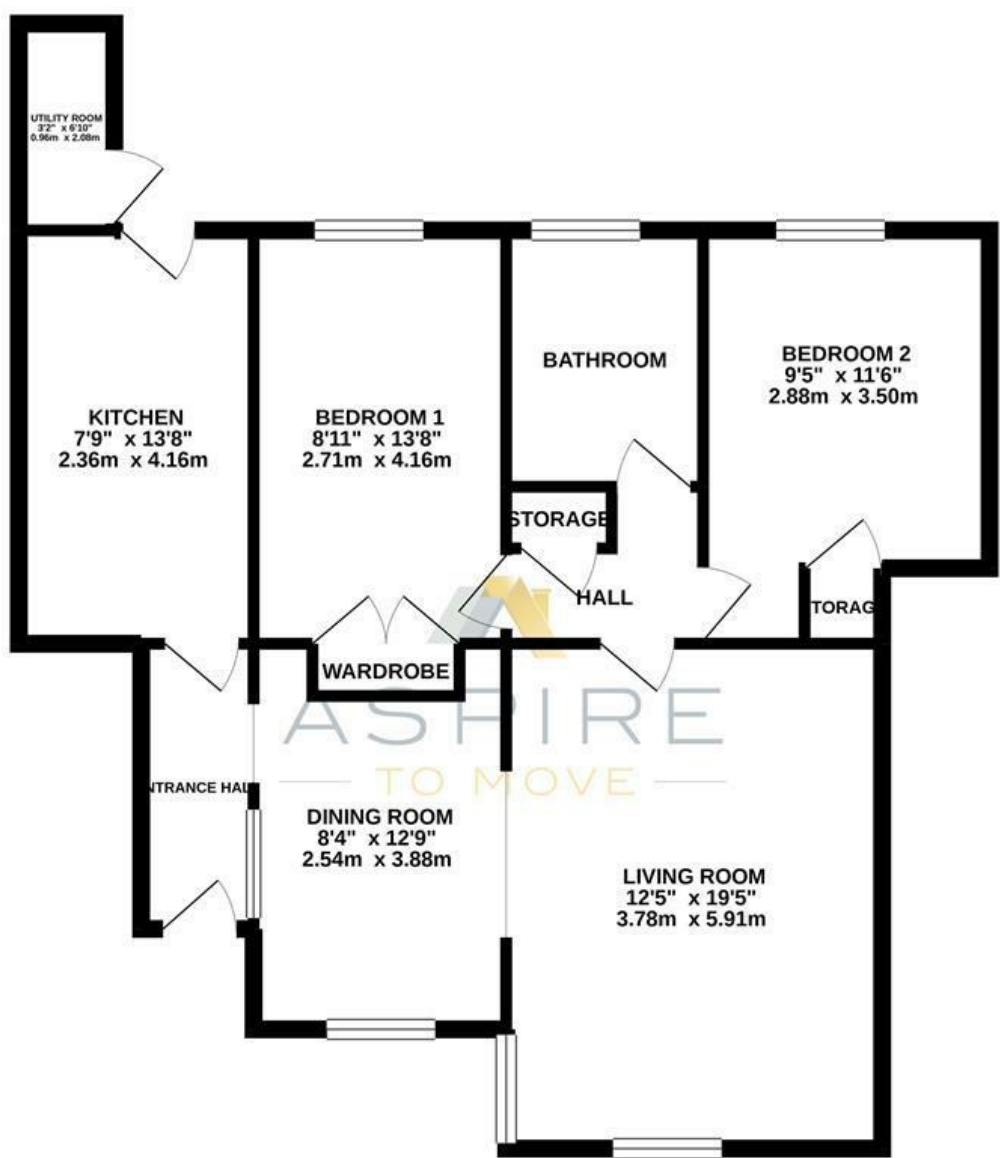

LANDSDOWN MANSIONS

TOTAL FLOOR AREA : 797 sq. ft. (74.1 sq. m.) approx.

Whilst every attempt has been made to ensure the accuracy of the floorplan contained here, measurements of doors, windows, rooms and any other items are approximate and no responsibility is taken for any error, omission or mis-statements. This plan is for illustrative purposes only and should be used as such by any prospective purchaser. The services, systems and appliances shown have not been tested and no guarantee as to their operability or efficiency can be given.

Made with Metropix ©2020

These particulars, whilst believed to be accurate are set out as a general outline only for guidance and do not constitute any part of an offer or contract. Intending purchasers should not rely on them as statements of representation of fact, but must satisfy themselves by inspection or otherwise as to their accuracy. No person in this firms employment has the authority to make or give any representation or warranty in respect of the property.

